

# Suspension Schematic: Hendrickson Rear Haulmax (Revised)

[Schematic](#) [Parts List](#)

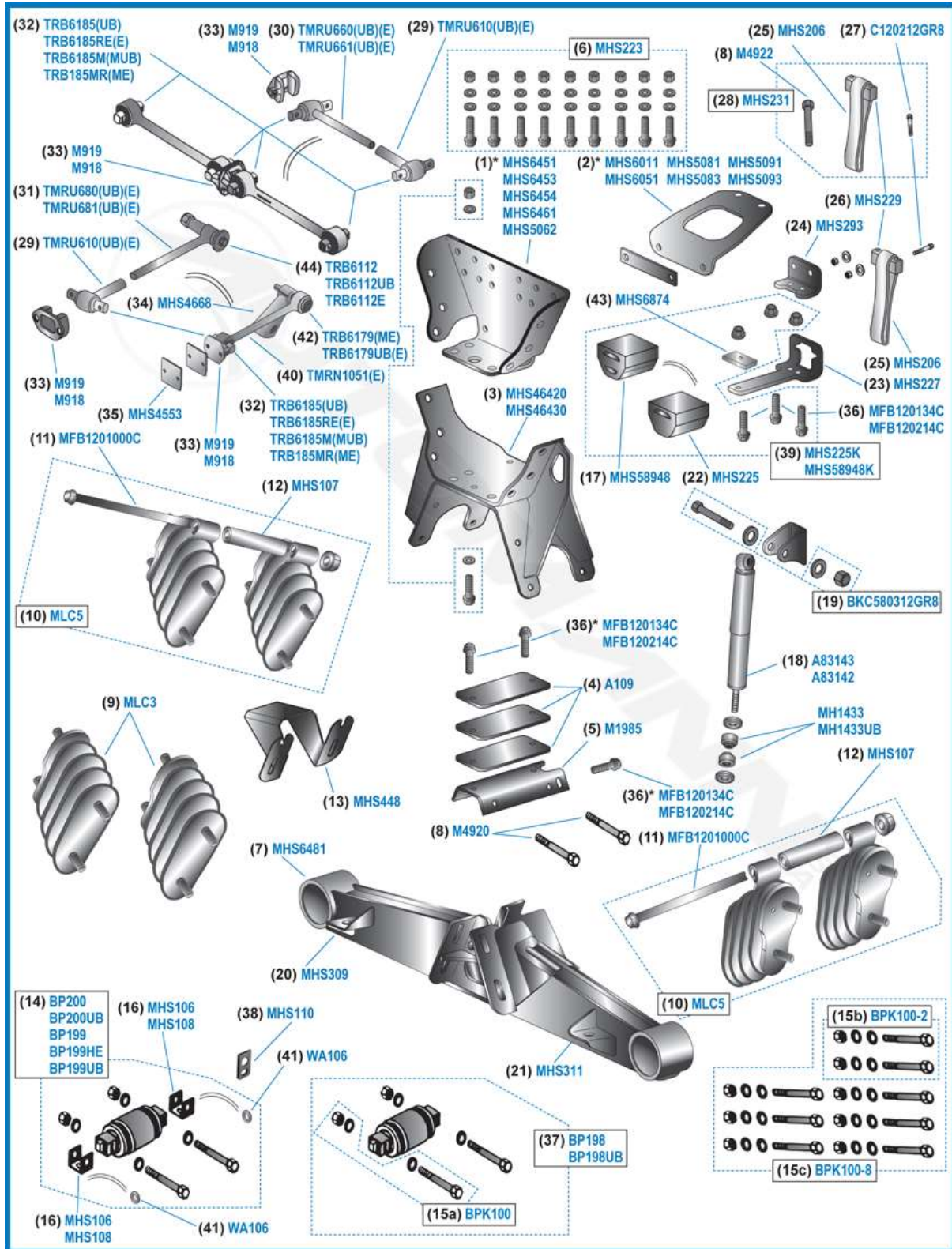

Home	Category ▾	Brand ▾	Make/Model ▾	New Arrivals ▾	Wizards ▾	Schematics ▾	Quick Links ▾	Help ▾
Key	Part No.	OEM Ref.	Req.	Description	Notes			
1	<a href="#">MHS6451</a>	64595101	2	Outer Frame Bracket	IHC, 34.12" - 34.25", 16.5" Rd. Hgt.			
1	<a href="#">MHS6453</a>	64595003	2	Outer Frame Bracket	Haulmaax, 34", 18.5" Rd. Hgt., Oshkosh, Paccar & Western Star			
1	<a href="#">MHS6454</a>	64595104	2	Outer Frame Bracket	IHC, 34.68" - 34.94", 16.5" Rd. Hgt.			
1	<a href="#">MHS6461</a>	64636001	2	Outer Frame Bracket	FRT, 34.3" - 34.5", 16.5" Rd. Hgt.			
1	<a href="#">MHS5062</a>	64636002	2	Outer Frame Bracket	FRT, 34.3" - 34.5", 17.5" Rd. Hgt.			
1	Ref.	Various	2	Outer Frame Bracket	Verify All With OEM			
2	<a href="#">MHS6011</a>	60617101	2	Inner Frame Bracket	IHC, 34.12" - 34.25", 16.5" Rd. Hgt.			
2	<a href="#">MHS6051</a>	60617501	2	Inner Frame Bracket	FRT-WWS, 34.30" - 34.50", 16.5" Rd. Hgt.			
2	<a href="#">MHS5081</a>	65078001	2	Inner Frame Bracket	Osh-Ken-Pete w/Liner, 34", 16.5" Rd. Hgt.			
2	<a href="#">MHS5083</a>	65078003	2	Inner Frame Bracket	CCC-Osh, Ken-Pete w-Liner, 34"			
2	<a href="#">MHS5091</a>	65079001	2	Inner Frame Bracket	Ken-Pete w/o Liner, 34.0" - 34.75", 16.5" Rd. Hgt.			
2	<a href="#">MHS5093</a>	65079003	2	Inner Frame Bracket	Ken-Pete w/o Liner, 34.0" - 34.75", 18.5" Rd. Hgt.			
2	Ref.	Various	2	Inner Frame Bracket	Verify All With OEM			
3	<a href="#">MHS46420</a>	64642000	2	Saddle Assembly	Verify All With OEM, After 1/12/03, 400 Series			
3	<a href="#">MHS46430</a>	64643000	2	Saddle Assembly	Verify All With OEM, After 1/12/03, 460 Series			
4	<a href="#">A109</a>	60791000	6	Auxiliary Spring Shim	1/4" Tk.			
5	<a href="#">M1985</a>	59191001/ 59191000	2	Contact Plate	For Auxiliary Spring			
6	<a href="#">MHS223</a>	64179039	1	Saddle Fastener Kit	Does 2 Saddles			
7	<a href="#">MHS6481</a>	64846001	2	Walking Beam	Verify, View Charts on Page 19-112 for Additional OEM's			
8	<a href="#">M4922</a>	21867023	2	Bolt Only	3/4"-16 x 6-1/2" Lg.			
9	<a href="#">MLC3</a>	64179002 / 59257000	8	Bolster Spring Kit	64179002 = 2 pcs., w/o Tie Bar, 59257000 Spring Only			
10	<a href="#">MLC5</a>	64179037	4	Bolster Spring Kit	w/Tie Bar, 65743000 Spring Only			
11	<a href="#">MFB1201000C</a>	60818003	4	Bolster Spring Bolt	1/2"-13 x 10.0" Flange Head, use FLNC102			
12	<a href="#">MHS107</a>	65742000	4	Bolster Spring Spacer	1/2" ID X 1.0" OD x 4.7" Lg.			
13	<a href="#">MHS448</a>	64890000	4	Wear Plate	OEM# Was 64179005			
14	<a href="#">BP200</a>	34013088	4	Bar Pin Bushing Kit	w/Bar Pin Bushing, w/MHS108 Shims & Hrdw.			
14	<a href="#">BP200UB</a>		4	Bar Pin Bushing Kit	Poly, w/Bar Pin Bushing, w/MHS108 Shims & Hrdw.			
14	<a href="#">BP199</a>	34013188L	4	Bar Pin Bushing Kit	Free Rotating Pin w/MHS108 Shims & Hrdw.			
14	<a href="#">BP199HE</a>	34013188L	4	Bar Pin Bushing Kit	OEM Kit			
14	<a href="#">BP199UB</a>		4	Bar Pin Bushing Kit	Poly, Non-Rotating Pin w/WA106 Shims & Hrdw.			
15a	<a href="#">BPK100</a>	48941000	8	Bar Pin Bolt Kit	1.0"-8 x 6.0" Lg. Gr8, Incl. Nut & Washers			
15b	<a href="#">BPK100-2</a>	48941000	8	Bar Pin Bolt Kit	1.0"-8 x 6.0" Lg. Gr8, Incl. Nut & Washers			
15c	<a href="#">BPK100-8</a>	48941000	8	Bar Pin Bolt Kit	1.0"-8 x 6.0" Lg. Gr8, Incl. Nut & Washers			
16	<a href="#">MHS106</a>	50130000	A/R	Alignment Shim	3/16" Tk.			
16	<a href="#">MHS108</a>	50131000	A/R	Alignment Shim	1/8" & 1/4" Tk.			
17	<a href="#">MHS58948</a>	67778000	2	Auxiliary Spring				
18	<a href="#">A83143</a>	60680004	4	Shock	16-1/2" Saddle Hgt., ES162/S42			
18	<a href="#">A83142</a>	60680005	4	Shock	17-1/2" - 18-1/2" Saddle Hgt., ES162/S42			
19	<a href="#">BKC580312GR8</a>	32043000	4	Bolt Kit	5/8"-11 x 3-1/2" Lg., OEM is 3-1/4" Lg.			
20	<a href="#">MHS309</a>	64148001	2	Lower Shock Bracket	Front			



Automann / Interchange Part # or Keyword

Call: 1-888-288-6626

Text: 856-263-4600

Home Category Brand Make/Model New Arrivals Wizards Schematics Quick Links Help

23	<a href="#">MHS227</a>	59384000	2	Auxiliary Spring Bracket	
24	<a href="#">MHS293</a>	60613000	2	Rebound Support Angle	
25	<a href="#">MHS206</a>	57878003 / 57878000	2	Rebound Strap	
26	<a href="#">MHS229</a>	60612000	2	Rebound Strap Clip	
27	<a href="#">C120212GR8</a>	60818002	4	Bolt	1/2"-13 x 2-1/2", OEM is 2-1/4"
28	<a href="#">MHS231</a>	64179028	2	Rebound Strap Kit	
29	<a href="#">TMRU610</a>	46610	A/R	T/Rod End	Female Straddle, Can Use TMRN610 (66610)
29	<a href="#">TMRU610UB</a>		A/R	T/Rod End	Poly
29	<a href="#">TMRU610E</a>		A/R	T/Rod End	Poly, Rotational
30	<a href="#">TMRU660</a>	46660	A/R	T/Rod End	Male Straddle, 30-1/2", Can Use TMRN660 (66660)
30	<a href="#">TMRU660UB</a>		A/R	T/Rod End	Poly
30	<a href="#">TMRU660E</a>		A/R	T/Rod End	Poly, Rotational
30	<a href="#">TMRU661</a>	46661	A/R	T/Rod End	Male Straddle, 22-1/2", Can Use TMRN661 (66661)
30	<a href="#">TMRU661UB</a>		A/R	T/Rod End	Poly
30	<a href="#">TMRU661E</a>		A/R	T/Rod End	Poly, Rotational
31	<a href="#">TMRU680</a>	46680	A/R	T/Rod End	Male Taper Stud, 30-1/2", Can Use TMRN680 (66680)
31	<a href="#">TMRU680UB</a>		A/R	T/Rod End	Poly
31	<a href="#">TMRU680E</a>		A/R	T/Rod End	Poly, Rotational
31	<a href="#">TMRU681</a>	46681	A/R	T/Rod End	Male Taper Stud, 22-1/2", Can Use TMRN681 (66681)
31	<a href="#">TMRU681UB</a>		A/R	T/Rod End	Poly
31	<a href="#">TMRU681E</a>		A/R	T/Rod End	Poly, Rotational
32	<a href="#">TRB6185</a>	47691000		T/Rod Bushing	2.0" OD x 4-3/8" CtoC w/ 5/8" Bolts, Rubber, Non Rotational
32	<a href="#">TRB6185UB</a>			T/Rod Bushing	Poly, Non Rotational
32	<a href="#">TRB6185RE</a>			T/Rod Bushing	Rubber, Rotational
32	<a href="#">TRB6185E</a>			T/Rod Bushing	Poly, Rotational
32	<a href="#">TRB6185M</a>			T/Rod Bushing	Rubber, w/Metal Sleeve, Non Rotational
32	<a href="#">TRB6185MUB</a>			T/Rod Bushing	Poly, w/Metal Sleeve, Non Rotational
32	<a href="#">TRB6185MR</a>			T/Rod Bushing	Rubber, w/Metal Sleeve, Rotational
32	<a href="#">TRB6185ME</a>			T/Rod Bushing	Poly, w/Metal Sleeve, Rotational
33	<a href="#">M919</a>	22186000	2	T/Rod Frame Bracket	For 5/8" Bolts x 4-3/8" CtoC
33	<a href="#">M918</a>	30828000	2	T/Rod Frame Bracket	For 3/4" Bolts x 4-3/8" CtoC
34	<a href="#">MHS4668</a>	46868000	2	T/Rod Axle Bracket	Meritor SQ100, SQHP, SL100 Axles, Verify
35	<a href="#">MHS4553</a>	45045003	2	Reinforce Plate	For T/Rod
36	<a href="#">MFB120134C</a>	60818001		Flanged Bolt	1/2"-13 x 1-3/4" Lg., OEM is 1-1/2" Lg.
36	<a href="#">MFB120214C</a>	60818002		Flanged Bolt	1/2"-13 x 2-1/4" Lg.
36	Ref.	67290001		Flanged Bolt	5/8"-11 x 1-1/2" Lg., After 11/07, Verify, Can Use MFB580200C
37	<a href="#">BP198</a>	34013087	4	Bar Pin Bushing Kit	Non Shim, w/Bushing & Hrdw.
37	<a href="#">BP198UB</a>		4	Bar Pin Bushing Kit	Poly
38	<a href="#">MHS110</a>	57026000	A/R	Alignment Shim	3/8" Tk.
39	<a href="#">MHS225K</a>	64179004	2	Auxiliary Spring Kit	Uses MHS225 Pad
39	<a href="#">MHS58948K</a>	65902004	2	Auxiliary Spring Kit	Uses MHS58948 Pad, 2-A109, 5-MFB120214C & Hdrw.



Automann / Interchange Part # or Keyword

Call: 1-888-288-6626

Text: 856-263-4600

Home Category Brand Make/Model New Arrivals Wizards Schematics Quick Links Help

41	<a href="#">WA106</a>		8	Alignment Shim	3/16" Tk., Use w/BP199UB only
42	<a href="#">TRB6179</a>	64697000	A/R	T/Rod Bushing	2.0" OD
42	<a href="#">TRB6179UB</a>		A/R	T/Rod Bushing	Poly
42	<a href="#">TRB6179E</a>		A/R	T/Rod Bushing	Premium Poly
42	<a href="#">TRB6179ME</a>		A/R	T/Rod Bushing	Metal Sleeve, Poly
43	<a href="#">MHS6874</a>	60874000	2	Aux Spring Plate	40K-46K
44	<a href="#">TRB6112</a>	44697000	A/R	T/Rod Bushing	2.0" OD
44	<a href="#">TRB6112UB</a>		A/R	T/Rod Bushing	Poly
44	<a href="#">TRB6112E</a>		A/R	T/Rod Bushing	Metal Sleeve, Poly

© 2023 Automann USA, Inc. All rights reserved. All content is property of Automann, and may not be reproduced or redistributed in any form.



888-AUTOMANN (+1-888-288-6626)

Any reference to OEM names or OEM product identification numbers/descriptions/model numbers is for identification only and does not indicate that it is an OEM part. When ordering, customers have the option to order using industry references, OEM references or Automann references.