

## Suspension Schematic: Watson & Chalin Lift SL2055, SL2065 (New)

[Schematic](#) [Parts List](#)

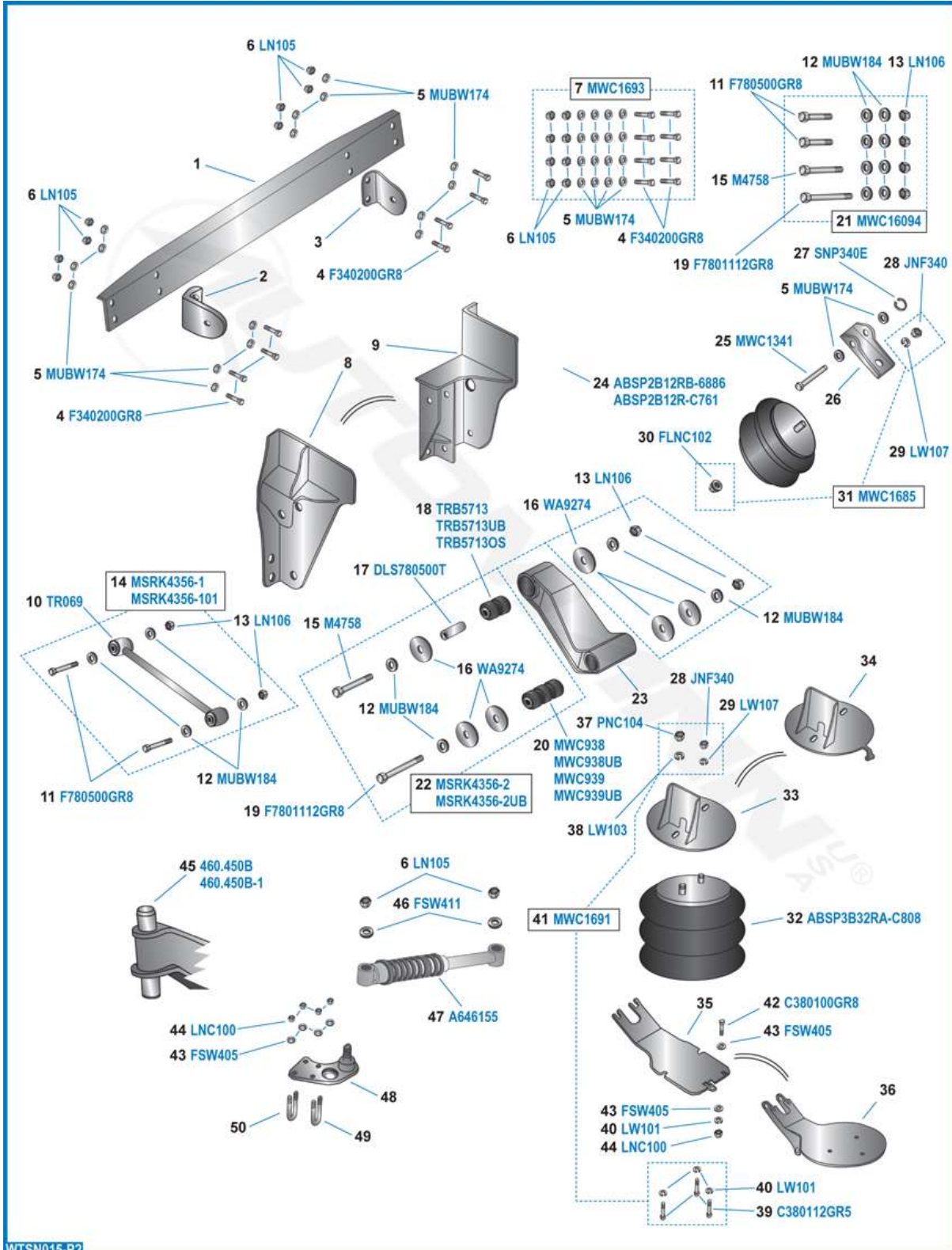

Home	Category	Brand	Make/Model	New Arrivals	Wizards	Schematics	Quick Links	Help
Key	Part No.	OEM Ref.	Req.	Description	Notes			
1	Ref.	9142801	1	Crossmember	SL2055, 33.5" Frame Width			
1	Ref.	91428	1	Crossmember	SL2055, 34.0" Frame Width			
1	Ref.	9142802	1	Crossmember	SL2055, 34.5" Frame Width			
1	Ref.	9184101	1	Crossmember	SL2065, 33.5" Frame Width			
1	Ref.	91841	1	Crossmember	SL2065, 34.0" Frame Width			
1	Ref.	9184102	1	Crossmember	SL2065, 34.5" Frame Width			
1	Ref.	9184103	1	Crossmember	SL2065, 35.0" Frame Width			
2	Ref.	2159510	1	Inner Arm Pivot Plate	LH, SL2055			
3	Ref.	2159520	1	Inner Arm Pivot Plate	RH, SL2055			
4	<a href="#">F340200GR8</a>	10896	8	Bolt	3/4"-16 x 2.0" Lg. Gr8			
5	<a href="#">MUBW174</a>	10043	16	Washer	3/4" Id.			
6	<a href="#">LN105</a>	10028	8	Lock Nut	3/4"-16 Gr C			
7	<a href="#">MWC1693</a>	16093 / HPCM16093	1	Crossmember Hardware Pack	8-F340200GR8, 16-MUBW174, 8-LN105			
8	Ref.	92066410	1	Frame Hanger	LH, SL2055			
8	Ref.	92066420	1	Frame Hanger	RH, SL2055			
9	Ref.	9208801X8	1	Frame Hanger	LH, SL2065, 8" Rail Hgt.			
9	Ref.	9208801X9	1	Frame Hanger	LH, SL2065, 9" Rail Hgt.			
9	Ref.	9208801X0	1	Frame Hanger	LH, SL2065, 10" Rail Hgt.			
9	Ref.	9208802X8	1	Frame Hanger	RH, SL2065, 8" Rail Hgt.			
9	Ref.	9208802X9	1	Frame Hanger	RH, SL2065, 9" Rail Hgt.			
9	Ref.	9208802X0	1	Frame Hanger	RH, SL2065, 10" Rail Hgt.			
10	<a href="#">TR069</a>	17832	2	Upper T-Rod				
11	<a href="#">F780500GR8</a>	172385	4	Bolt	7/8"-14 x 5.0" Lg.			
12	<a href="#">MUBW184</a>	17010	16	Flat Washer	7/8" ID, 1-1/2" OD, OEM is 1-3/4" OD			
13	<a href="#">LN106</a>	11457	8	Lock Nut	7/8"-14			
14	<a href="#">MSRK4356-1</a>	SRK2055-1	1	Torque Rod Kit	Does One Axle, 2-TR069, 4-F780500GR8, 8-MUBW184, 4-LN106			
14	<a href="#">MSRK4356-101</a>	SRK2055-1-01	2	Torque Rod Kit	Does One Side, 1-TR069, 2-F780500GR8, 4-MUBW184, 2-LN106			
15	<a href="#">M4758</a>	172388	2	Bolt	7/8"-14 x 8.0" Lg.			
16	<a href="#">WA9274</a>	1122202	12	Washer	0.9" ID, 4-1/4" OD, 1/4" Thk.			
17	<a href="#">DLS780500T</a>	1716105	2	Delrin Sleeve	7/8" ID x 1.0" OD x 5.0" Lg., OEM is 4-1/2" Lg.			
18	<a href="#">TRB5713</a>	10050	2	Pivot Bushing				
18	<a href="#">TRB5713UB</a>		2	Pivot Bushing	Poly			
18	<a href="#">TRB5713OS</a>		2	Pivot Bushing	Oversized			
19	<a href="#">F7801112GR8</a>	1723811.5	2	Bolt	7/8"-14 x 11-1/2" Lg.			
20	<a href="#">MWC938</a>	11938 / 1193801	2	Axle End Bushing	1.125" ID, May need to use DLS780700			
20	<a href="#">MWC938UB</a>		2	Axle End Bushing	Poly, 1.125" ID, May need to use DLS780700			
20	<a href="#">MWC939</a>	1193891	2	Axle End Bushing	0.915" ID			
20	<a href="#">MWC939UB</a>		2	Axle End Bushing	Poly, 0.915" ID			
1	<a href="#">MWC16094</a>	16094 / HPPT16094	2	Pivot Connection Bolt Kit	Pivot Connection, 2-M4758, 4-780500GR8, 2-F7801112GR8, 16-MUBW184, 8-LN106			



Home	Category	Brand	Make/Model	New Arrivals	Wizards	Schematics	Quick Links	Help
22	<a href="#">M3RRA4330720B</a>	<a href="#">3RNR203372</a>	1	Bushing Nut	DOES ONE AXLE, 2-TIRDS/130B, 2-MWVC3330B, 2-FLC37003001, 2-T/001112GR5, 8-MUBW184, 2-M4758, 4-LN106, 12-WA9274			
23	Ref.	93027410	1	Beam Assembly	LH			
23	Ref.	93027420	1	Beam Assembly	RH			
24	<a href="#">ABSP2B12RB-6886</a>	AS00581F	2	Air Spring	Lift, SL2055			
24	<a href="#">ABSP2B12R-C761</a>	AS0058C	2	Air Spring	Lift, SL2065			
25	<a href="#">MWC1341</a>	1903401	2	Clevis Pin	3/4" ID x 5.0" Lg.			
26	Ref.	5019301	2	Lift Bag Plate				
27	<a href="#">SNP340E</a>	19027	2	Snap Ring	E Style, 3/4"			
28	<a href="#">JNF340</a>	10025	2	Jam Nut	3/4"-16			
29	<a href="#">LW107</a>	10026	2	Lock Washer	3/4" ID x 3/16" Thk.			
30	<a href="#">FLNC102</a>	19534	2	Flange Nut	1/2"-13			
31	<a href="#">MWC1685</a>	16085 / HPLT16085	1	Air Spring Hardware Kit	Lift, 2-LW107, 2-JNF340, 2-FLNC102			
32	<a href="#">ABSP3B32RA-C808</a>	AS0222	2	Air Spring				
33	Ref.	950262	2	Upper Air Spring Plate	SL2055			
34	Ref.	95026210	1	Upper Air Spring Plate	LH, SL2065, 8.0" Rail Hgt.			
34	Ref.	95026212	1	Upper Air Spring Plate	LH, SL2065, 9.0" Rail Hgt.			
34	Ref.	95026213	1	Upper Air Spring Plate	LH, SL2065, 10.0" Rail Hgt.			
34	Ref.	95026220	1	Upper Air Spring Plate	RH, SL2065, 8.0" Rail Hgt.			
34	Ref.	95026222	1	Upper Air Spring Plate	RH, SL2065, 9.0" Rail Hgt.			
34	Ref.	95026223	1	Upper Air Spring Plate	RH, SL2065, 10.0" Rail Hgt.			
35	Ref.	95026312	1	Lower Air Spring Plate	LH, SL2055XX X-10			
35	Ref.	95026313	1	Lower Air Spring Plate	LH, SL2055XX X-11			
35	Ref.	95026322	1	Lower Air Spring Plate	RH, SL2055XX X-10			
35	Ref.	95026323	1	Lower Air Spring Plate	RH, SL2055XX X-11			
36	Ref.	95301012	1	Lower Air Spring Plate	LH, SL2065XX X-10			
36	Ref.	95301013	1	Lower Air Spring Plate	LH, SL2065XX X-11			
36	Ref.	95301014	1	Lower Air Spring Plate	LH, SL2065XX X-12			
36	Ref.	95301015	1	Lower Air Spring Plate	LH, SL2065XX X-13			
36	Ref.	95301022	1	Lower Air Spring Plate	RH, SL2065XX X-10			
36	Ref.	95301023	1	Lower Air Spring Plate	RH, SL2065XX X-11			
36	Ref.	95301024	1	Lower Air Spring Plate	RH, SL2065XX X-12			
36	Ref.	95301025	1	Lower Air Spring Plate	RH, SL2065XX X-13			
37	<a href="#">PNC104</a>	10030	2	Lock Nut	1/2"-13			
38	<a href="#">LW103</a>	10042	2	Lock Washer	1/2" ID x 1/8" Thk.			
39	<a href="#">C380112GR5</a>	10039	6	Bolt	3/8"-16 x 1-1/2" Lg.			
40	<a href="#">LW101</a>	10041	6	Lock Washer	3/8" ID			
41	<a href="#">MWC1691</a>	1605901 / HPLD2055	1	Air Spring Hardware Kit	2-JNF340, 2-LW107, 2-PNC104, 2-LW103, 6-C380112GR5, 6-LW101			



44	<a href="#">LNC100</a>	11094, 11678	2	Lock Nut	3/8"-16
45	<a href="#">460.450B</a>	SRK107	1	King Pin Kit	SL2065, Does One Axle
45	<a href="#">460.450B-1</a>	SRK107-1	2	King Pin Kit	SL2065, Does One Side
46	<a href="#">FSW411</a>	17070	4	Flat Washer	0.938" ID, 1.75" OD, 0.141" Thk.
47	<a href="#">A646155</a>	11418	2	Steer Shock	
48	Ref.	9904810	1	Outer Stabilizer Bracket	LH
48	Ref.	9904820	1	Outer Stabilizer Bracket	RH
49	Ref.	1754901	2	Ubolt	Sq. 3/8"-16 x 2.0" x 2-1/2"
50	Ref.	17510	2	Ubolt	Rd. 3/8"-16 x 3-1/2"

© 2023 Automann USA, Inc. All rights reserved. All content is property of Automann, and may not be reproduced or redistributed in any form.



888-AUTOMANN (+1-888-288-6626)

Any reference to OEM names or OEM product identification numbers/descriptions/model numbers is for identification only and does not indicate that it is an OEM part. When ordering, customers have the option to order using industry references, OEM references or Automann references.